

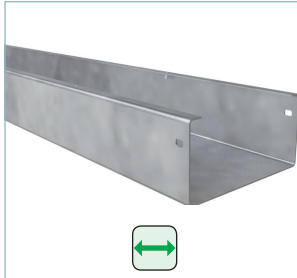

**WT**



L = 2 m (6,6 ft)

	CTA (Kg/m)	(Kg)	B		H		GS	
			mm	inch	mm	inch	REF.	kg/m
WT 100X100	21	150	100	4	100	4	2/10146	5,50
WT 200X100	45	150	200	8	100	4	2/10147	7,06
WT 300X100	69	150	300	12	100	4	2/10148	8,62
WT 400X100	93	150	400	16	100	4	2/10149	10,19
WT 500X100	117	150	500	20	100	4	2/10150	11,74
WT 600X100	141	150	600	24	100	4	2/10151	13,30

- 2 x JUWT
- 2m x WT --> 3 x SV (B)
- B ≥ 400 --> 1 x PSWT
- 

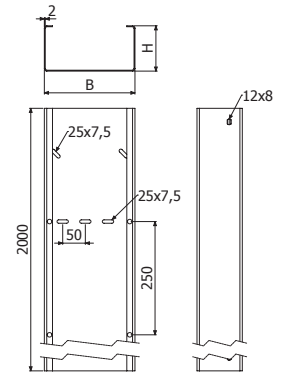

**TWT**

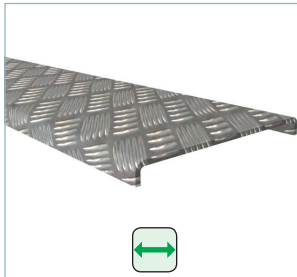

L = 2 m (6,6 ft)

	(Kg)	B		AL	
		mm	inch	REF.	kg/m
TWT 100	150	100	4	2/10191	1,63
TWT 200	150	200	8	2/10192	2,84
TWT 300	150	300	12	2/10193	4,05
TWT 400	150	400	16	2/10194	5,26
TWT 500	150	500	20	2/10195	6,47
TWT 600	150	600	24	2/10196	7,68

- 6/100 x DIN 7991 M6x16 (2/10265 - EZ)
- 1 x PSWT (2/10180) --> TWT (400 - 600)

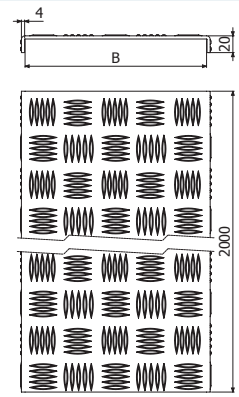

**TSWT**

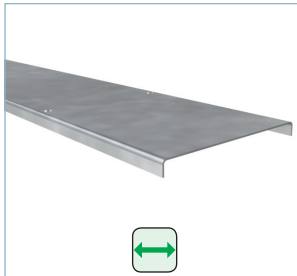

L = 2 m (6,6 ft)

	B	GS		
		mm	inch	REF.
TSWT 100	100	4	2/10185	2,19
TSWT 200	200	8	2/10186	3,76
TSWT 300	300	12	2/10187	5,34
TSWT 400	400	16	2/10188	6,91
TSWT 500	500	20	2/10189	8,49
TSWT 600	600	24	2/10190	10,16

- 6/100 x DIN 7991 M6x16 (2/10265 - EZ)
- 

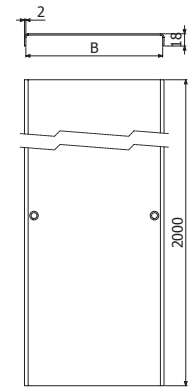

**CPWT**



	(Kg)	B		H		GS	
		mm	inch	mm	inch	REF.	kg/ud
CPWT 100X100	150	100	4	100	4	2/10152	1,85
CPWT 200X100	150	200	8	100	4	2/10153	2,99
CPWT 300X100	150	300	12	100	4	2/10154	4,44
CPWT 400X100	150	400	16	100	4	2/10155	6,21
CPWT 500X100	150	500	20	100	4	2/10156	8,30
CPWT 600X100	150	600	24	100	4	2/10157	10,69

- 4/100 x B1 (2/4356 -EZ)
- 1 x CPWT --> 1 x SV (B)
- JUWT

