

EMC locknuts, brass nickel-plated



EMMU-EMV



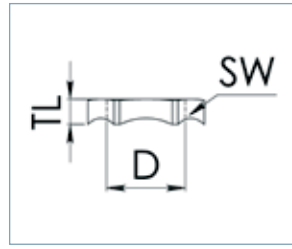

MMU-EMV





Material: Brass nickel-plated

EMMU-EMV, metric

Type	WISKA-No. Ni	 D (mm)	 SW (mm)	TL (mm)	
EMMU-EMV 12	10063210	M 12x1,5	15	4,7	100
EMMU-EMV 16	10063211	M 16x1,5	19	4,7	100
EMMU-EMV 20	10063212	M 20x1,5	24	4,7	100
EMMU-EMV 25	10063213	M 25x1,5	30	5,2	100
EMMU-EMV 32	10063214	M 32x1,5	36	5,7	100
EMMU-EMV 40	10063215	M 40x1,5	46	6,5	50
EMMU-EMV 50	10063216	M 50x1,5	60	7	50
EMMU-EMV 63	10063217	M 63x1,5	70	7	25
EMMU-EMV 75	10102228	M 75x1,5	80	10	1

MMU-EMV, PG

Type	WISKA-No. Ni	 D (mm)	 SW (mm)	TL (mm)	
MMU-EMV 7	10063218	PG 7	15	4,7	100
MMU-EMV 9	10063219	PG 9	18	4,7	100
MMU-EMV 11	10063220	PG 11	21	4,7	100
MMU-EMV 13,5	10063221	PG 13,5	23	4,7	100
MMU-EMV 16	10063222	PG 16	26	4,7	100
MMU-EMV 21	10063223	PG 21	32	5,2	50
MMU-EMV 29	10063224	PG 29	41	5,7	50
MMU-EMV 36	10063225	PG 36	51	6,5	50
MMU-EMV 42	10063226	PG 42	60	7	50
MMU-EMV 48	10063227	PG 48	64	7	50

POLYAMIDE  
POLYAMIDE ACCESSORIES  
MEMBRANE  
BRASS  
BRASS ACCESSORIES  
MARITIME  
STAINLESS STEEL  
EMC  
EX E / I  
EX D  
ENTRANCE  
BS  
SEALING TOOLS  
ACTION BOXES  
TECHNICS  
INDEX